



ENGEL JACOBS
LONDON+HERTS



- One Bedroom Maisonette
- En-Suite Bathroom
- Garage
- Large Reception
- Allocated Parking Space
-



Kennedy Close
St. Albans

Monthly Rental Of
£1,500

Entrance Hall

Carpeted stairs up to landing.

Bedroom 16' 2" x 12' 4" (4.92m x 3.76m)

Carpeted throughout, double glazed windows to front aspect, fitted blinds, radiators, spotlights.

Bathroom

Tiled floor, partly tiled walls, floating wash basin with mixer tap and storage, mirrored bathroom cabinet, bath with overhead rain shower and handheld shower, low level WC, heated towel rail.

Kitchen 12' 4" x 6' 6" (3.76m x 1.98m)

Tiled floor, double glazed windows to front aspect, fully fitted units both wall mounted and base, Zanussi single oven and gas hob, Currys slim line dishwasher, Aquarius washer/dryer, Bosch fridge/freezer, ample work surface area, radiator, spotlights.

Reception 17' 5" x 11' 8" (5.30m x 3.55m)

Laminate flooring throughout, double glazed windows to front aspect, radiator spotlights.

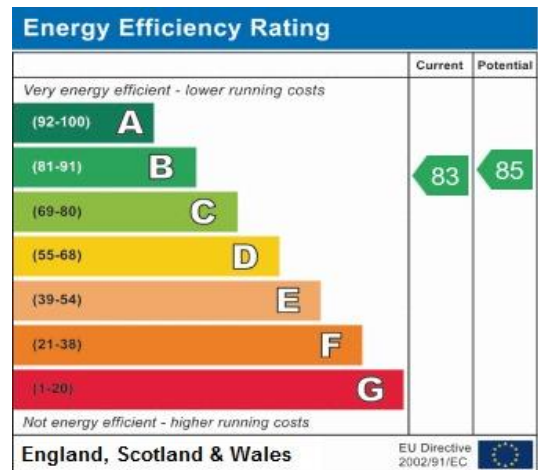

Address:
Kennedy Close, London Colney

Flat Entrance

Approx. 5.5 sq. metres (58.9 sq. feet)

First Floor

Approx. 57.8 sq. metres (622.6 sq. feet)

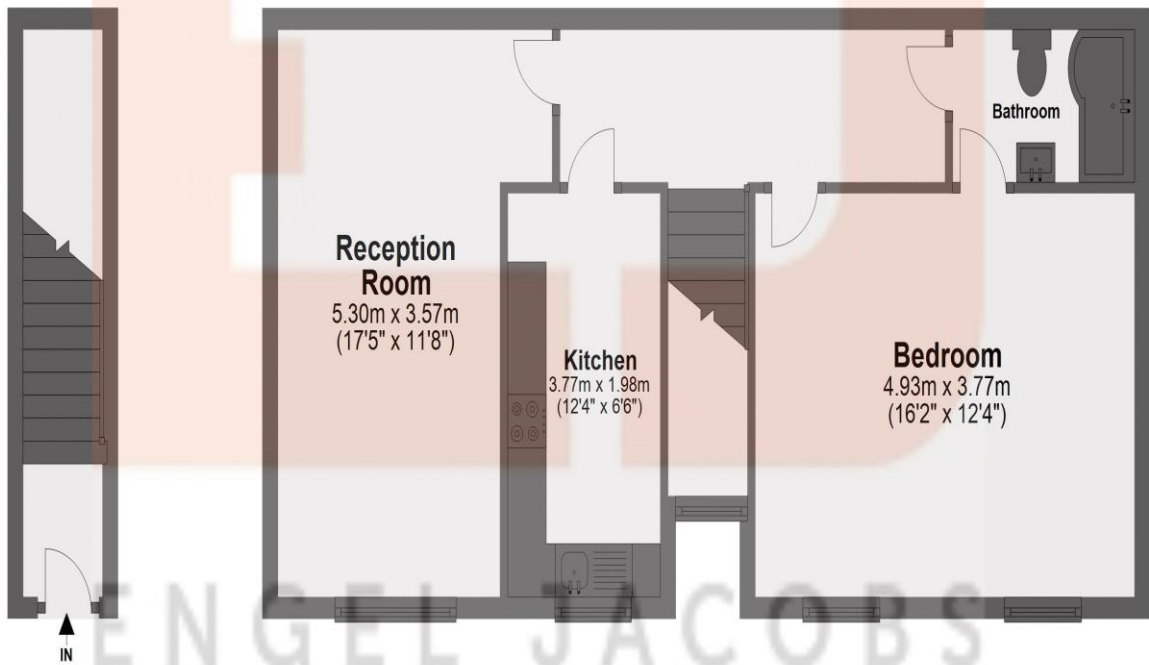

Total area: approx. 63.3 sq. metres (681.6 sq. feet)